

东储2021-22号政府储备地宗地图

北

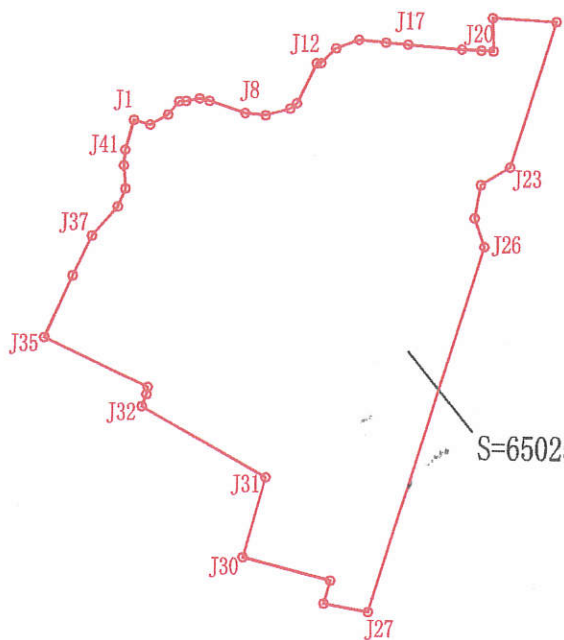

S=65025.57平方米, 合97.5384亩

界址点坐标表

界址点坐标表

点号	X	Y	边长	点号	X	Y	边长
J1	2113088.129	463944.332	10.89	J20	2113135.739	464174.082	21.33
J2	2113085.286	463954.850	13.12	J21	2113157.050	464173.105	40.94
J3	2113091.937	463966.155	11.09	J22	2113154.995	464213.988	97.86
J4	2113100.517	463973.174	4.43	J23	2113061.327	464185.657	21.74
J5	2113100.795	463977.599	8.81	J24	2113049.968	464167.116	21.97
J6	2113102.678	463986.210	6.43	J25	2113028.284	464163.563	19.43
J7	2113101.280	463992.488	24.03	J26	2113009.999	464170.131	246.11
J8	2113093.877	464015.351	13.30	J27	2112774.426	464098.879	28.75
J9	2113092.706	464028.601	16.27	J28	2112779.510	464070.586	15.31
J10	2113097.156	464044.252	5.61	J29	2112794.265	464074.652	58.25
J11	2113100.690	464048.605	28.36	J30	2112808.526	464018.177	53.51
J12	2113126.298	464060.801	2.79	J31	2112860.175	464032.170	91.47
J13	2113126.501	464063.581	13.65	J32	2112904.532	463952.172	8.37
J14	2113136.193	464073.190	15.45	J33	2112912.362	463955.132	4.66
J15	2113141.735	464087.609	17.50	J34	2112916.972	463955.826	73.69
J16	2113140.273	464105.052	14.04	J35	2112948.228	463889.099	43.38
J17	2113139.170	464119.051	34.64	J36	2112987.849	463906.771	28.38
J18	2113136.677	464153.602	12.54	J37	2113013.613	463918.675	24.92
J19	2113136.179	464166.130	7.96	J38	2113032.456	463934.986	12.52
J20	2113135.739	464174.082		J39	2113044.086	463939.612	

界址点坐标表

点号	X	Y	边长
J39	2113044.086	463939.612	14.85
J40	2113058.883	463938.333	10.01
J41	2113068.870	463939.020	19.98
J1	2113088.129	463944.332	

S=65025.57 平方米 合97.5384亩

制图时间: 2021年8月19日
2021年8月解析法测绘界址点
本坐标系采用国家大地2000坐标系(109度带)

1:5600

测量: 单观平
制图: 王熊帅



东方市测绘服务中心