

东预征2024-4号宗地图

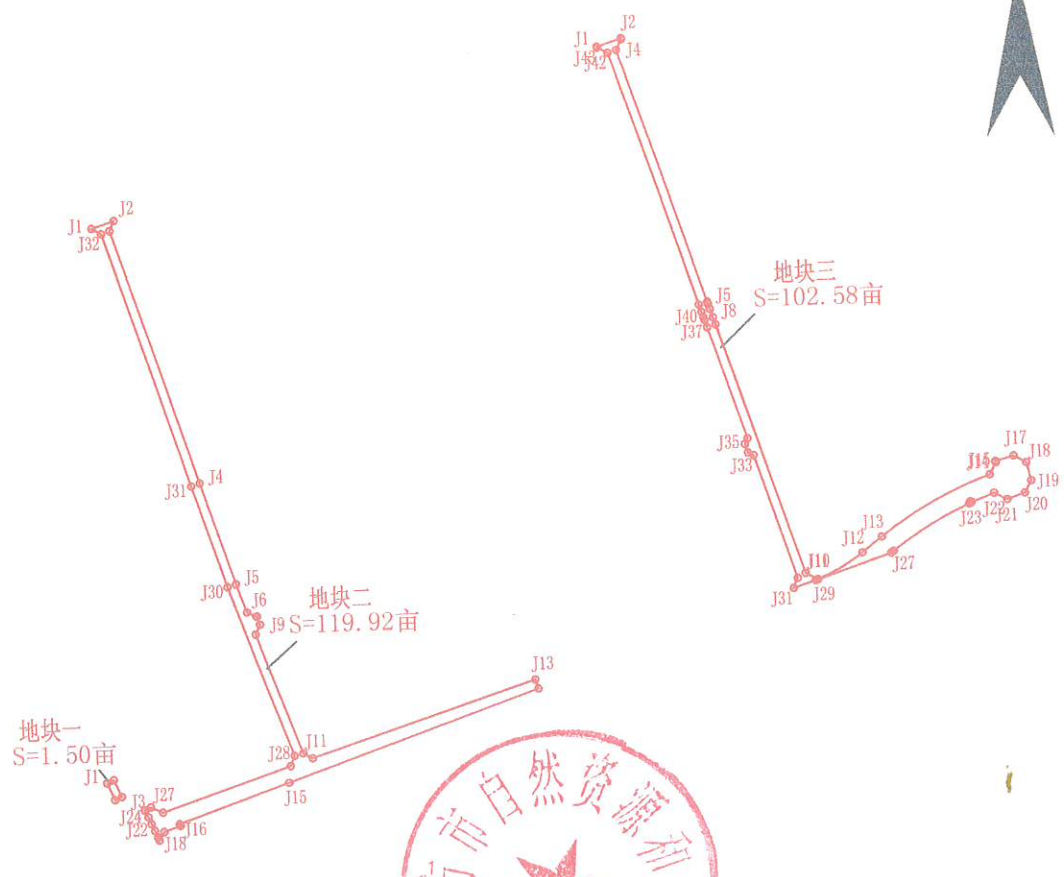

地块三界址点坐标表

点号	X	Y	边长
J20	2104161.364	464739.554	50.06
J21	2104145.138	464692.197	39.1
J22	2104163.563	464657.705	65.48
J23	2104139.756	464596.708	3.33
J24	2104141.584	464593.919	4.74
J25	2104137.965	464590.851	1.32
J26	2104136.886	464590.093	237.46
J27	2104015.761	464385.848	7.98
J28	2104010.882	464379.528	208.04
J29	2103945.896	464189.849	5.49
J30	2103944.189	464175.63	63.08
J31	2103924.789	464115.606	29.49
J32	2103951.817	464127.401	349.82
J33	2104284.165	464018.056	16.89
J34	2104291.778	464003.011	23.99
J35	2104314.499	463995.326	17.03
J36	2104672.373	463894.189	316.31
J37	2104630.133	463904.189	20.48
J38	2104649.591	463897.788	9.23
J39	2104658.357	463894.902	14.76
J40	2104672.373	463890.289	20.42
J41	2104691.744	463883.842	717.03
J42	2105372.863	463659.778	31.72
J43	2105387.224	463631.494	2.5
J1	2103389.601	463630.725	

地块二界址点坐标表

点号	X	Y	边长
J1	2103389.601	463630.725	68.94
J2	2105410.843	463696.314	2.5
J3	2105408.46	463697.066	31.86
J4	2105380.051	463682.66	716.94
J5	2104699.037	463906.762	5.97
J6	2104693.368	463908.628	14.32
J7	2104679.766	463913.104	24.18
J8	2104656.797	463920.662	20.49
J9	2104637.339	463927.065	708.7
J10	2103964.153	464148.589	37.27
J11	2103946.6	464181.468	138.44
J12	2104014.315	464302.215	67.68
J13	2104055.31	464355.316	332.31
J14	2104213.025	464647.818	36.59
J15	2104245.58	464664.568	2.86
J16	2104248.322	464663.808	49.97
J17	2104261.576	464711.983	38.12
J18	2104242.713	464745.111	49.99
J19	2104194.275	464757.487	37.48
J20	2104161.364	464739.554	

地块二界址点坐标表

点号	X	Y	边长
J20	2103306.456	462390.369	20.06
J21	2103324.717	462382.653	20.03
J22	2103342.933	462373.734	20
J23	2103361.419	462366.088	20.02
J24	2103379.416	462357.328	1.66
J25	2103380.851	462356.706	17.7
J26	2103387.965	462372.915	35.96
J27	2103373.009	462405.617	363.76
J28	2103487.115	462751.018	29.78
J29	2103514.609	462762.448	486.62
J30	2103372.286	462597.196	287.49
J31	2104245.79	462508.544	717.93
J32	2104928.524	462297.44	29.38
J1	2104943.737	462262.138	

地块一界址点坐标表

点号	X	Y	边长
J1	2103456.243	462258.042	62.95
J2	2103463.171	462222.019	29.37
J3	2103468.218	462210.254	717.94
J4	2104253.176	462531.36	287.09
J5	2103980.057	462919.828	81.44
J6	2103903.458	462947.495	27.74
J7	2103891.213	462872.382	2.38
J8	2103891.933	462674.634	23.98
J9	2103869.092	462981.942	28.78
J10	2103843.268	462689.236	342.91
J11	2103820.753	462785.728	28.84
J12	2103506.437	462816.762	633.19
J13	2103700.107	463413.611	25.57
J14	2103675.8	463421.551	714.33
J15	2103443.047	462746.308	313.95
J16	2103340.751	462449.391	5.63
J17	2103335.6	462451.659	46.7
J18	2103320.95	462407.312	26.26
J19	2103258.441	462393.787	8.71
J20	2103306.456	462390.369	

地块一界址点坐标表

点号	X	Y	边长
J1	2103456.243	462258.042	19.98
J2	2103464.289	462276.335	49.96
J3	2103418.555	462296.452	19.99
J4	2103410.508	462278.158	49.96
J1	2103456.243	462258.042	

S=998.5 平方米 合1.50亩

海南道铭测绘科技有限公司

绘图日期：2024年03月01日

1:35000

绘图员：王熊帅

2000国家大地坐标系(109°)

绘图员：单松柏